

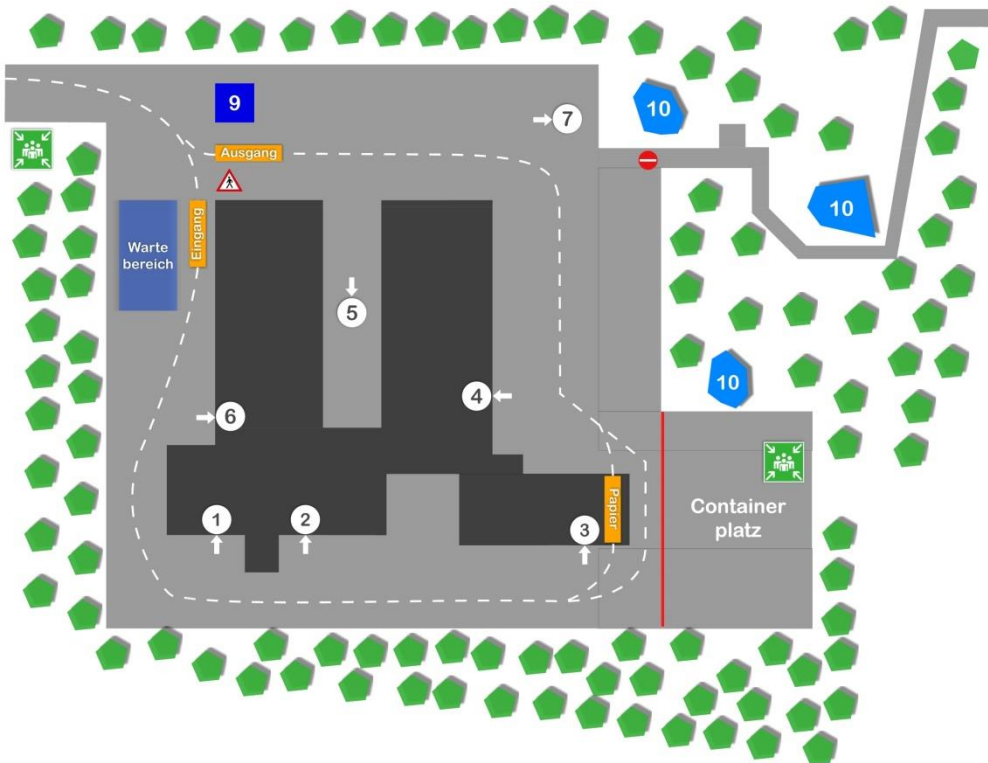





Factory premises Böhme GmbH



- ① Hall 1
- ② Hall 2
- ③ Hall 3
- ④ Delivery PPK
- ⑤ Press / Courtyard
- ⑥ Canpress
- ⑦ Bale storage / box outside
- ⑧ Scale for vehicle
- ⑨ Fire protection pond
- ⑩ mehrwertstoffhof
- Assembly point

Rule book

-  It applies the hanging operating regulations!
-  On the whole area is true for the StVO!
-  The one-way street regulation applies throughout the entire site!
-  On the whole area you have to drive walking speed!
-  Stacker and wheel loader got right of way!
-  Wear protective equipment (hard-toed shoe, reflective vest, etc.)!
-  The work area is at most 2 meters around vehicle!
-  On the whole area there is an absolute smoking ban!
-  **If it burns go to the assembly point immediately**
(in front of the entrance, at container place)!

Rules of conduct during loading and unloading

- The driver have to wait at an assigned parking area, till a colleague from Böhme GmbH is calling him.
- Only after request you can pull the net over or open the awning at an intended place. You get the information from Stacker driver and/ or wheel loader driver. You can do this in intended areas in compliance with all safety regulations.
- Only for loading an unloading you can leave your vehicle. To enter the hall and to walk around the premises is forbidden.
- To stay on the loading floor during loading and unloading is forbidden.
- The driver undertakes to secure the cargo before departure for safe operation and transport in compliance with statutory regulations.
- Children are only allowed to enter the grounds under the supervision of their legal guardians.
- In case of emergency or fire, the emergency alarm plan, which is suspended in the scale office, must be observed.
- Generally, the instructions of the personnel must be followed.
- Escaping liquides (oils, fuels, etc.) must be immediately to the employees of Böhme GmbH.
- Before somebody handles with toxins, you have to inform somebody from the scale office.

We accept no liability for any damage resulting from non-compliance with these operating regulations